

Angular Contact Ball Bearings

Brass cage angular contact ball bearing-7207 BECBY

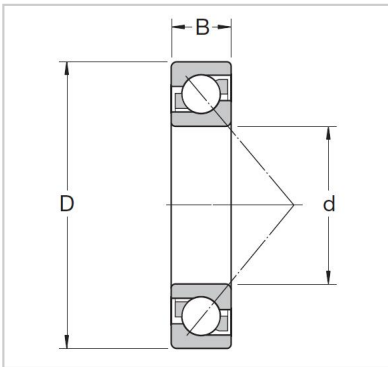

Abutment and fillet dimensions

Db max.	7207 BECBY
Da max.	7207 BEP
da min.	35
rb max.	72
ra max.	17

Dimensions

a	29.1
r3,4 min.	19
r1,2 min	0.815
D1	11 000
d2	11 000
d1	0.28

Mass

KG	49.7
----	------

Speed ratings r/min

Limiting speed	42
Reference speed	58.3

Fatigue load limit

Pu kN	1.1
-------	-----

Basic load ratings KN

dynamic C kN	0.6
static Co kN	31

Basic design bearing

B mm	42
D mm	65
d mm	67.8

Basic design bearing

Universally matchable bearing	0.6
-------------------------------	-----